

# Lockplates

**AL / ALL**  
**MS 31 / MS 30**

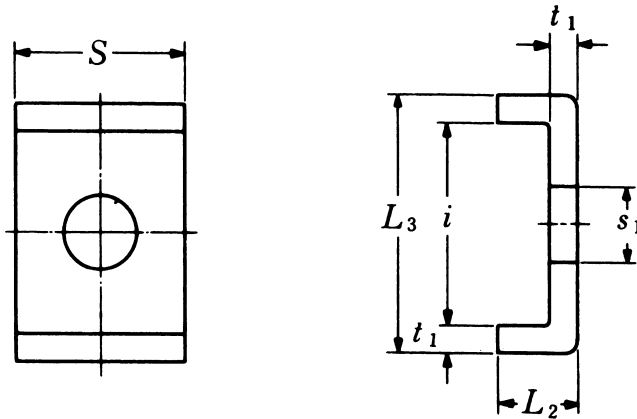

Lock Plate	t <sub>1</sub>	S	L <sub>2</sub>	s <sub>1</sub>	i	L <sub>3</sub>	Suitable Lock Nut No.	Weight per 100 pieces (kgs)
Part No.	mm	mm	mm	mm	mm	mm		
AL 44	4	20	12	9	22.5	30.5	AN 44	2.600
AL 48	4	20	12	9	22.5	30.5	AN 48	2.600
AL 52	4	24	12	12	25.5	33.5	AN 52	3.390
AL 56	4	24	12	12	25.5	33.5	AN 56	3.390
AL 60	4	24	12	12	30.5	38.5	AN 60	3.790
AL 64	5	24	15	12	31	41	AN 64	5.350
AL 68	5	28	15	14	38	48	AN 68	6.650
AL 72	5	28	15	14	38	48	AN 72	6.650
AL 76	5	32	15	14	40	50	AN 76	7.960
AL 80	5	32	15	18	45	55	AN 80	8.200
AL 84	5	32	15	18	45	55	AN 84	8.200
AL 88	5	36	15	18	43	53	AN 88	9.000
AL 92	5	36	15	18	43	53	AN 92	9.000
AL 96	5	36	15	18	53	63	AN 96	10.400
AL 100	5	40	15	18	45	55	AN 100	10.500
ALL 44	4	20	12	7	13.5	21.5	ANL 44	2.120
ALL 48	4	20	12	9	17.5	25.5	ANL 48	2.290
ALL 52	4	20	12	9	17.5	25.5	ANL 52	2.290
ALL 56	4	24	12	9	17.5	25.5	ANL 56	2.920
ALL 60	4	24	12	9	20.5	28.5	ANL 60	3.160
ALL 64	5	24	15	9	21	31	ANL 64	4.560
ALL 68	5	24	15	9	21	31	ANL 68	4.560
ALL 72	5	28	15	9	20	30	ANL 72	5.030
ALL 76	5	28	15	12	24	34	ANL 76	5.280
ALL 80	5	28	15	12	24	34	ANL 80	5.280
ALL 84	5	32	15	12	24	34	ANL 84	6.110
ALL 88	5	32	15	14	28	38	ANL 88	6.450
ALL 92	5	32	15	14	28	38	ANL 92	6.450
ALL 96	5	36	15	14	28	38	ANL 96	7.290
ALL 100	5	36	15	14	28	38	ANL 100	7.290

NOTE : 1) The specifications of AL can be applied for MS 31。AL 的尺寸規格適用於 MS 31。

2) The specifications of ALL can be applied for MS 30。ALL 的尺寸規格適用於 MS 30。