

Lockwashers

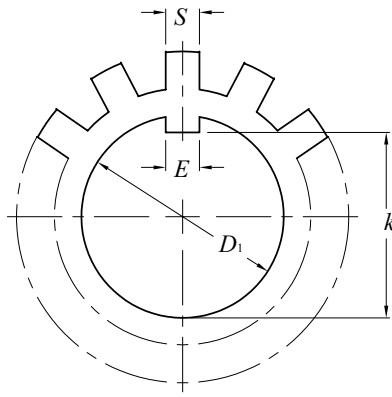

AW MB

Lock washer ¹⁾ Part No.	D_1 mm	k mm	E mm	t mm	S mm	D_4 mm	D_5 mm	Number of tongues	Weight per 100 pieces (kgs)	Lock Nut No.
AW 33	165	157.5	18	2.5	16	193	222	19	24.100	AN 33
AW 34	170	164	18	2.5	16	193	232	19	24.700	AN 34
AW 36	180	174	20	2.5	18	203	242	19	26.800	AN 36
AW 38	190	184	20	2.5	18	214	252	19	27.800	AN 38
AW 40	200	194	20	2.5	18	226	262	19	29.300	AN 40
AW 44	220	213	24	3.0	20	250	292	19	48.300	AN 44
AW 48	240	233	24	3.0	20	270	312	19	50.200	AN 48
AW 52	260	253	28	3.0	24	300	342	23	72.900	AN 52
AW 56	280	273	28	3.0	24	320	362	23	75.900	AN 56

NOTE : The specifications of AW can be applied for MB 。 AW 的尺寸規格適用於 MB 。

AWL MBL

Lock washer ¹⁾ Part No.	D_1 mm	k mm	E mm	t mm	S mm	D_4 mm	D_5 mm	Number of tongues	Weight per 100 pieces (kgs)	Lock Nut No.
AWL 24	120	115	14	2	12	135	151	19	7.700	ANL 24
AWL 26	130	125	14	2	12	145	161	19	8.700	ANL 26
AWL 28	140	135	16	2	12	155	171	19	10.900	ANL 28
AWL 30	150	145	16	2	14	170	188	19	11.300	ANL 30
AWL 32	160	154	18	2.5	14	180	199	19	16.200	ANL 32
AWL 34	170	164	18	2.5	16	190	211	19	19.000	ANL 34
AWL 36	180	174	20	2.5	16	200	221	19	18.000	ANL 36
AWL 38	190	184	20	2.5	16	210	231	19	20.500	ANL 38
AWL 40	200	194	20	2.5	18	222	248	19	21.400	ANL 40

NOTE : The specifications of AWL can be applied for MBL 。 AWL 的尺寸規格適用於 MBL 。