

Adapter Sleeves

H 3
HE 3
HS 3
HA 3

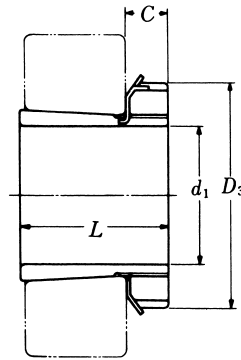

TAPER 1:12

Adapter ¹⁾ Part No.	d ₁				L mm	D ₃ mm	C mm	Lock Nut	Lock Washer	Weight (kgs)
	H mm	HE ²⁾ in	HS ³⁾ in	HA ⁴⁾ in						
H 304	17	—	—	—	28	32	7	AN 04	AW 04	0.045
H 305	20	¾	⅞	—	29	38	9	AN 05	AW 05	0.075
H 306	25	1	⅞	15/16	31	45	9	AN 06	AW 06	0.109
H 307	30	—	1 ⅛	1 3/16	35	52	10	AN 07	AW 07	0.142
H 308	35	1 ¼	1 ⅜	1 5/16	36	58	11	AN 08	AW 08	0.189
H 309	40	1 ½	1 5/8	1 7/16	39	65	12	AN 09	AW 09	0.248
H 310	45	1 ¾	1 5/8	1 11/16	42	70	13	AN 10	AW 10	0.303
H 311	50	2	1 7/8	1 15/16	45	75	13	AN 11	AW 11	0.345
H 312	55	—	2 ⅛	—	47	80	13	AN 12	AW 12	0.394
H 313	60	2 ¼	2 3/8	2 3/16	50	85	14	AN 13	AW 13	0.458
H 314	60	—	—	—	52	92	14	AN 14	AW 14	0.723
H 315	65	2 ½	—	2 7/16	55	98	15	AN 15	AW 15	0.831
H 316	70	2 ¾	—	2 11/16	59	105	17	AN 16	AW 16	1.030
H 317	75	3	—	2 15/16	63	110	18	AN 17	AW 17	1.180
H 318	80	—	—	3 3/16	65	120	18	AN 18	AW 18	1.370
H 319	85	3 ¼	—	—	68	125	19	AN 19	AW 19	1.560
H 320	90	3 ½	—	3 7/16	71	130	20	AN 20	AW 20	1.690
H 321	95	—	—	—	74	140	20	AN 21	AW 21	1.950
H 322	100	4	—	3 15/16	77	145	21	AN 22	AW 22	2.180

Note :

- 1) Adapter sleeves are supplied complete with lock nuts and lock washers °
 整組緊定套附螺母及華司。
- 2) Adapter sleeves for these bores are designated HE , e.g. HE305 °
 此欄套筒內徑規格為 HE , 例如 HE305 °
- 3) Adapter sleeves for these bores are designated HS , e.g. HS305 °
 此欄套筒內徑規格為 HS , 例如 HS305 °
- 4) Adapter sleeves for these bores are designated HA , e.g. HA306 °
 此欄套筒內徑規格為 HA , 例如 HA306 °