

Locknuts

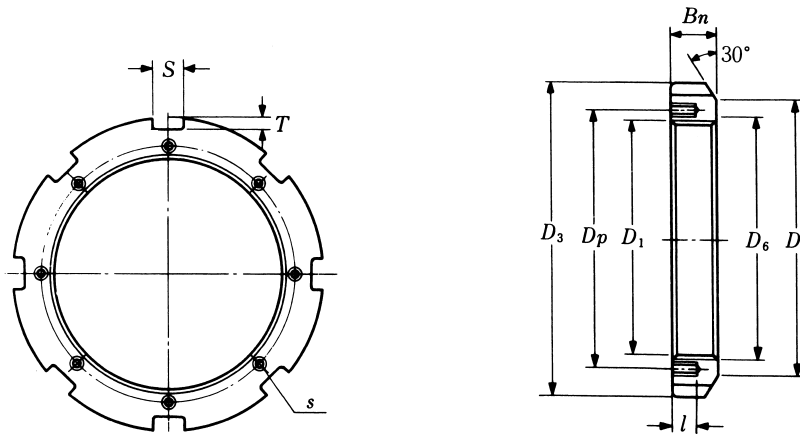

ANL HM 30

Lock Nut Part No.	D 1 Thread ¹⁾	D 3 mm	D 4 mm	S mm	T mm	D 6 mm	B n mm	i mm	Tapped Hole s Threads	D p mm	Suitable Lock Plate No.	Weight (kgs)
ANL 44	Tr 220 × 4	260	242	20	9	222	30	12	M 6 × 1.0	229	ALL 44	3.090
ANL 48	Tr 240 × 4	290	270	20	10	242	34	15	M 8 × 1.25	253	ALL 48	5.160
ANL 52	Tr 260 × 4	310	290	20	10	262	34	15	M 8 × 1.25	273	ALL 52	5.670
ANL 56	Tr 280 × 4	330	310	24	10	282	38	15	M 8 × 1.25	293	ALL 56	6.780
ANL 60	Tr 300 × 4	360	336	24	12	302	42	15	M 8 × 1.25	316	ALL 60	9.620
ANL 64	Tr 320 × 5	380	356	24	12	322.5	42	15	M 8 × 1.25	335	ALL 64	9.940
ANL 68	Tr 340 × 5	400	376	24	12	342.5	45	15	M 8 × 1.25	355	ALL 68	11.700
ANL 72	Tr 360 × 5	420	394	28	13	362.5	45	15	M 8 × 1.25	374	ALL 72	12.000
ANL 76	Tr 380 × 5	450	422	28	14	382.5	48	18	M10 × 1.5	398	ALL 76	14.900
ANL 80	Tr 400 × 5	470	442	28	14	402.5	52	18	M10 × 1.5	418	ALL 80	16.900
ANL 84	Tr 420 × 5	490	462	32	14	422.5	52	18	M10 × 1.5	438	ALL 84	17.400
ANL 88	Tr 440 × 5	520	490	32	15	442.5	60	21	M12 × 1.75	462	ALL 88	26.200
ANL 92	Tr 460 × 5	540	510	32	15	462.5	60	21	M12 × 1.75	482	ALL 92	29.600
ANL 96	Tr 480 × 5	560	530	36	15	482.5	60	21	M12 × 1.75	502	ALL 96	28.300
ANL 100	Tr 500 × 5	580	550	36	15	502.5	68	21	M12 × 1.75	522	ALL 100	33.600

Note :

- 1) Tr means 30°, trapezoid thread and the digits are major diameter of thread and pitch °
Tr 代表 30°，梯形螺紋；數字代表螺紋外徑及螺距。
- 2) The specifications of ANL can be applied for HM30 °
ANL 的尺寸規格適用於 HM30 °