

Withdrawal Sleeves

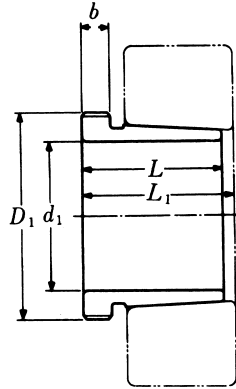

AH 22

TAPER 1:12

Withdrawal Part No.	d1 mm	L mm	L1 ¹⁾ mm	b mm	Thread ²⁾ D1 mm	Appropriate Withdrawal Nut No.	Weight (kgs)
AH 2236	170	105	110	17	M 200 × 3	AN 40	3.730
AH 2238	180	112	117	18	Tr 210 × 4	HN 42	4.250
AH 2240	190	118	123	19	Tr 220 × 4	HN 44	4.680
AH 2244	200	130	136	20	Tr 240 × 4	HN 48	9.100
AH 2248	220	144	150	21	Tr 260 × 4	HN 52	11.100
AH 2252	240	155	161	23	Tr 290 × 4	HN 58	14.000
AH 2256	260	155	163	24	Tr 310 × 5	HN 62	15.200
AH 2260	280	170	178	26	Tr 330 × 5	HN 66	18.100
AH 2264	300	180	190	27	Tr 350 × 5	HN 70	20.200

Note :

- 1) Dimension L1 decreases as the withdrawal sleeve is driven in during mouting。
L1尺寸隨退卸套鎖緊而變小。
- 2) M means metric thread , Tr means 30°, trapezoid thread and the digits are outside diameter of thread and pitch。
M 代表公制螺紋; Tr 代表 30°, 梯形螺紋; 數字代表螺紋外徑及螺距。