

# Withdrawal Sleeves

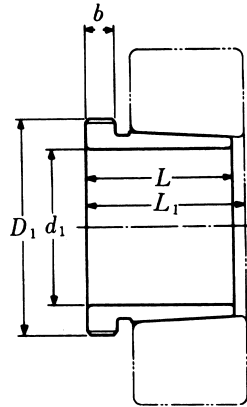

## AH 2

TAPER 1:12

Withdrawal Part No.	d <sub>1</sub> mm	L mm	L <sub>1</sub> <sup>1)</sup> mm	b mm	Thread <sup>2)</sup> D <sub>1</sub> mm	Appropriate Withdrawal Nut No.	Weight (kgs)
AH 208	35	25	27	6	M 45 × 1.5	AN 09	0.081
AH 209	40	26	29	6	M 50 × 1.5	AN 10	0.095
AH 210	45	28	31	7	M 55 × 2	AN 11	0.114
AH 211	50	29	32	7	M 60 × 2	AN 12	0.132
AH 212	55	32	35	8	M 65 × 2	AN 13	0.161
AH 213	60	32.5	36	8	M 75 × 2	AN 15	0.213
AH 214	65	33.5	37	8	M 80 × 2	AN 16	0.240
AH 215	70	34.5	38	8	M 85 × 2	AN 17	0.259
AH 216	75	35.5	39	8	M 90 × 2	AN 18	0.284
AH 217	80	38.5	42	9	M 95 × 2	AN 19	0.314
AH 218	85	40	44	9	M 100 × 2	AN 20	0.351
AH 219	90	43	47	10	M 105 × 2	AN 21	0.403
AH 220	95	45	49	10	M 110 × 2	AN 22	0.481
AH 222	105	50	54	11	M 120 × 2	AN 24	0.547

Note :

- 1) Dimension L<sub>1</sub> decreases as the withdrawal sleeve is driven in during mouting °  
L<sub>1</sub> 尺寸隨退卸套鎖緊而變小。
- 2) M means metric thread °  
M 代表公制螺紋。